

Salisbury Road

ST ANNE'S

APPROXIMATE FLOOR AREA
70.7 SQM / 761 SQFT



GROUND FLOOR
393 sq.ft. (36.5 sq.m.) approx.

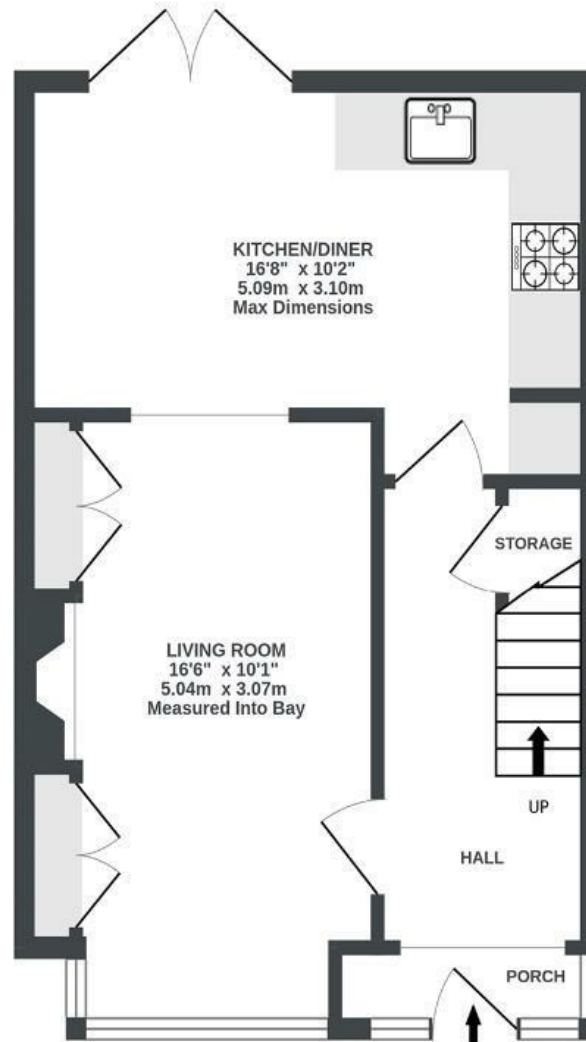

1ST FLOOR
368 sq.ft. (34.2 sq.m.) approx.

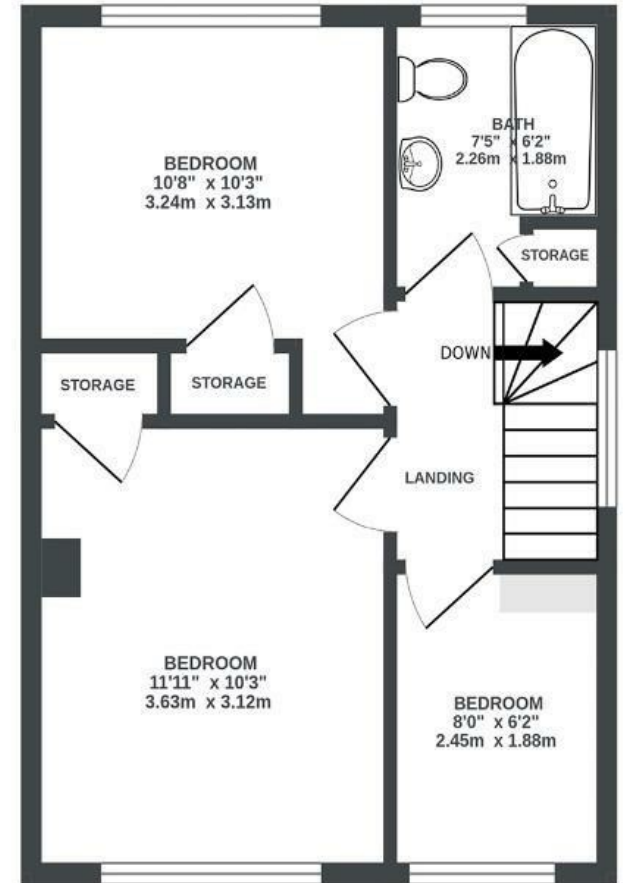

Illustrations are for reference purposes only, measurements are approximate, not to scale.

Boardwalk

Salisbury Road

ST. ANNES PARK, BRISTOL



£400,000



3 Bedrooms



BS4 4EL



1 Bathrooms

"We have loved living on Salisbury Road. The garden has been a tranquil place to enjoy the sunshine all day, and into the evening. We love sitting under the pergola and enjoying a morning coffee, or a Gin and Tonic in the evening surrounded by flowers, often watching hot air balloons float overhead. In the colder months the kitchen dining area becomes a place to be together, whilst one of us cooks and we discuss the events of the day. We love our kitchen, its perfect for a couple of foodies!"

